



Date: August, 2012

Doors intended for use in Smoke Partitions are, by code, non-rated". The label they bear indicates compliance with air leakage testing per UL-1784 only.

To comply with air leakage requirements a smoke control seal must be installed within the door-to-frame clearance as well as between leaves of pair doors or meeting rails of Dutch doors and door / transom assemblies.

The drawings below show typical installations. The seals indicated are for example, and any Category G smoke and draft control seal may be used. Different types of seals offer different advantages for specific applications. This instruction is not intended as a guide to the type of seal used for any specific opening.

Door to Frame Seal

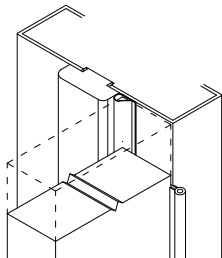

Seals between meeting edges of pair doors

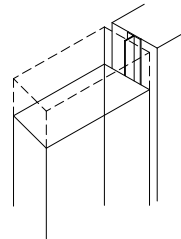

Seals between meeting rails (Dutch doors or Door/Transom assemblies)

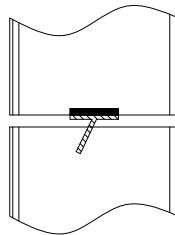
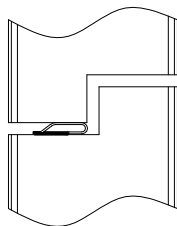

**Stile & Rail Doors, Door Frames,
Veneered Components, Plywood**

Two Rivers Division
One Eggers Drive
Two Rivers, WI 54241
Phone: 920.793.1351
Fax: 920.793.2958

www.eggersindustries.com

Flush Doors

Neenah Division
164 North Lake Street
Neenah, WI 54956
Phone: 920.722.6444
Fax: 920.722.0357

email: sales@eggersindustries.com