

Soundwood™

ACOUSTICAL WOOD PRODUCTS BY EGGERS 

STC 49-52

**The Highest Acoustical Ratings
in the Architectural
Wood Door Industry**



Eggers Industries

High-Performance Acoustical Doors with Lites

Eggers is proud to offer the highest acoustical ratings in the industry but we are also thrilled to be able to provide you with options. The STC 49 and 50 are available with a 100 sq. in. lite opening with standard lip wood bead.

This is a special construction 1-1/8" insulated glass unit that must be supplied and factory glazed by Eggers.

| ENGINEERING SPECIFICATIONS | | STC 49 and STC 50 |
|----------------------------|--|-------------------|
| | STC 49 | STC 50 |
| Sizes | Min. 2'-0" x 6'-0" Max. 4'-0" x 8'-0" | |
| Thickness | 1-3/4" | |
| Frame | Grouted 16 gauge welded steel | |
| Stiles | Veneered stile meets Extra Heavy Duty WDMA I.S. 1A Performance Level | |
| Rails | Structural Composite Lumber Core (SCL) | |
| Faces | Wood Veneers | |
| Fire-Rating | N/A | |
| Lites | 100 sq. in. - standard lip wood bead - 1-1/8" IGU | |
| Latching Hardware | Single point latch - cylindrical or mortise lock | |
| Hinges | Level swing - butt hinges | |
| Gasket System | U | S or T |
| Undercut | 3/8" | 3/8" |
| Test Report | C7672.01A | C5765.04 |
| Weight Per. Square Foot | 12.0 | |
| LEED® Contributions | LEED® MR4 - Recycled Content, EQ4.4 No Added Urea-Formaldehyde | |
| Standards | ASTM E90, E413 | |



Principle Benefits and Features of these Constructions

- Highest STC-rated 1-3/4" wood doors available
- Available with automatic door bottom or raised threshold
- Fixed or adjustable frame seals available
- Includes 1/8" total lead thickness which provides x-ray protection
- Meets LEED® EQ 4.4 - Low-Emitting Materials, No Added Urea Formaldehyde
- True wood composite construction - U.S. Patent No. 8,573,357
- The standard constructions for these doors include a full width top block for screw attachment of surface mounted closers

| | ENGINEERING SPECIFICATIONS | | STC 51 AND STC 52 |
|--------------------------------|--|--------|-------------------|
| | STC 51 | STC 52 | |
| Sizes | Min. 2'-0" x 6'-0" Max. 4'-0" x 8'-0" | | |
| Thickness | 1-3/4" | | |
| Frame | Grouted 16 gauge welded steel | | |
| Stiles | Veneered stile meets Extra Heavy Duty WDMA I.S. 1A Performance Level | | |
| Rails | Structural Composite Lumber Core (SCL) | | |
| Faces | Wood Veneers | | |
| Fire-Rating | N/A | | |
| Lites | N/A | | |
| Latching Hardware | Single point latch - cylindrical or mortise lock | | |
| Hinges | Level swing - butt hinges | | |
| Gasket System | U | S or T | |
| Undercut | 3/8" | 3/8" | |
| Test Report | C5765.03 | | |
| Weight Per. Square Foot | 12.0 | | |
| LEED® Contributions | LEED® MR4 - Recycled Content, EQ4.4 No Added Urea-Formaldehyde | | |
| Standards | ASTM E90, E413 | | |



GASKET SYSTEM U

Pemko S44, Pemko S773, Pemko ACP112 and Pemko 411 auto door bottom

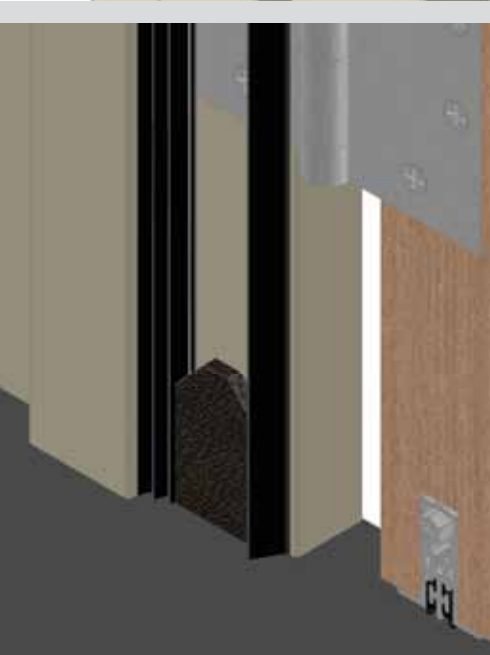
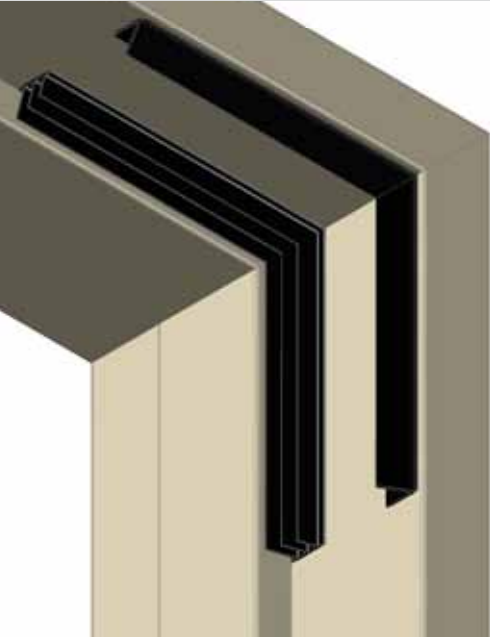

GASKET SYSTEM S

Pemko S44, Pemko 312CR with ER9, and Pemko 2008 STCxQ380 raised threshold

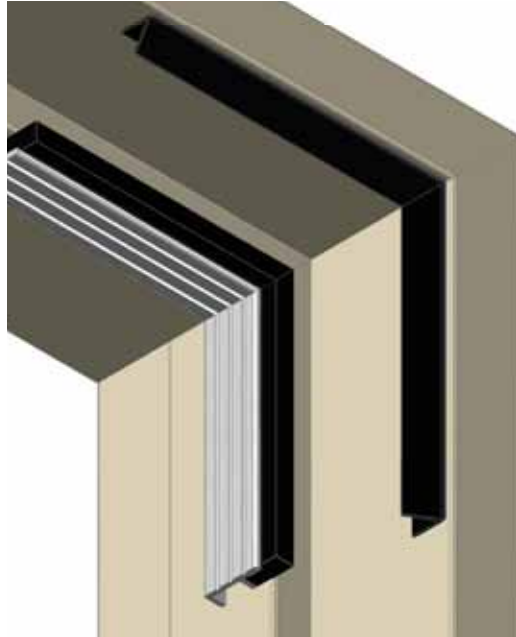

GASKET SYSTEM T

Pemko S44, Pemko S773 and Pemko 2008STCxQ380 raised threshold

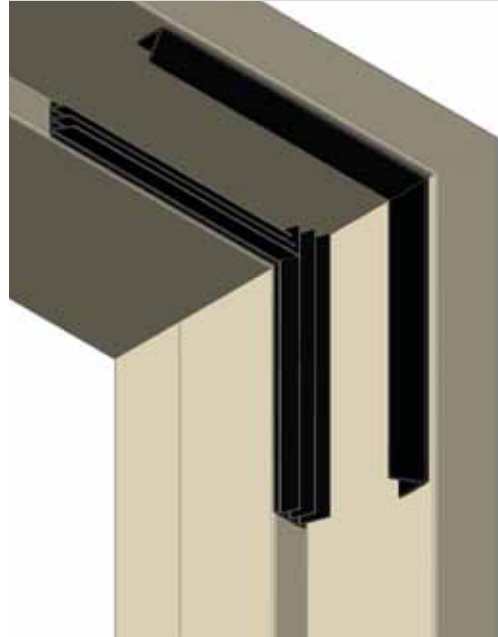

Eggers Industries
www.eggersindustries.com
sales@eggersindustries.com

Stile and Rail Doors, Door Frames Veneered Components, Plywood Flush Doors

Two Rivers Division
One Eggers Drive
Two Rivers, WI 54241
Phone: 920.793.1351
Fax: 920.793.2958

Neenah Division
164 North Lake Street
Neenah, WI 54956
Phone: 920.722.6444
Fax: 920.722.0357

Architectural Veneer Faces, Custom Wood Products, Plywood

Kentucky Division
2125 Lake Jericho Road
Smithfield, KY 40068
Phone: 502.845.0154
Fax: 502.849.0444