

The Classic Beauty of an Eggers' Door in
a Lightweight Construction...

Foam Core Doors

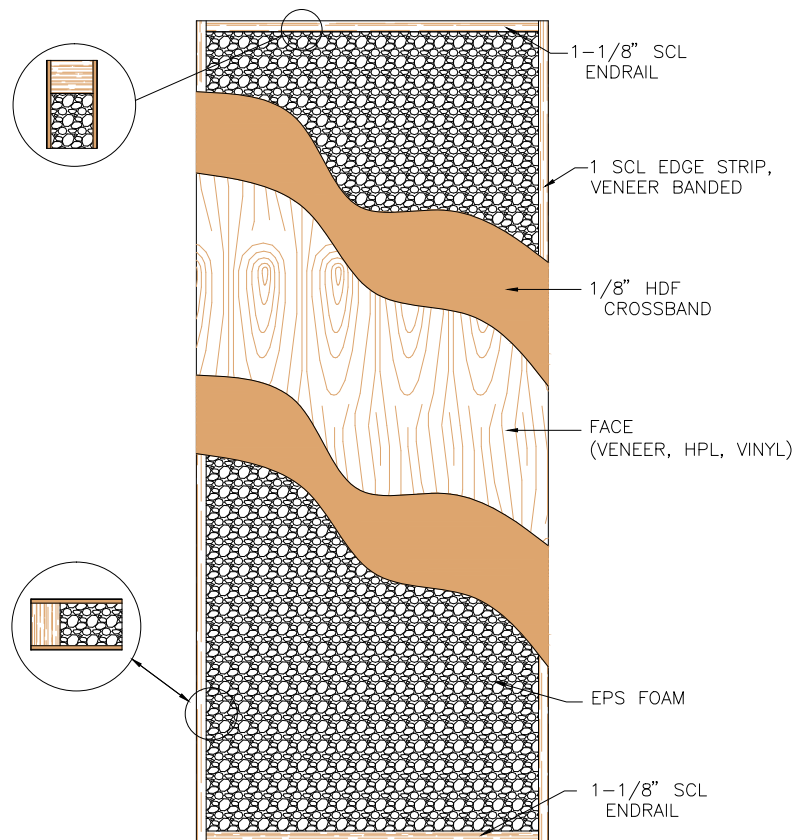

Eggers' Foam Core door is everything you would expect from an Eggers door...high-quality, innovative, and stunning. What you might not expect is its lightweight construction, creating an ease of use and flexibility standard weight doors cannot match.



Perfect for office systems, assisted living centers, sliding doors, or unique applications such as yachts. Eggers' Foam Core doors put less stress on the frame opening, are easier to move and install, and contribute towards LEED credits, all while offering the same beauty and style of Eggers' traditional wood core doors.

For more information or pricing on our Foam Core door offerings, please contact us at 920.722.6444 or visit www.eggersindustries.com.

ENGINEERING SPECIFICATIONS		NON-RATED FOAM CORE DOORS
Max. Size ¹	3' x 7' at 1-3/8" thickness	4' x 10' at 1-3/4" or 2-1/4" thickness
Core	Modified EPS Foam Core	
Weight	2.7 lbs. per square foot	
Stiles	1" structural composite lumber with matching or compatible veneered edges; solid lumber edges available	
Rails	1-1/8" structural composite lumber	
Reinforcements	Wide stiles, rails and blocking as requested or required	
Faces	All available domestic and foreign veneers; HPDL, MDO and Vinyl	
Crossbands	1/8" HDF	
Lites	Max. height 36"; one cutout per door; requires special liner built into core; 6" lite-lock margins from lite or lock cutout	
Latching Hardware	Most latching hardware allowed	
Hinges	Butt hinges; pocket pivots, continuous hinges	
Flushbolts	Automatic corner or extension bolts up to 36"	
Exit Hardware	Rim, surface vertical rod (full or top rod only), and concealed vertical rod exit hardware	
Closers, Stops, Holders	Concealed and surface hardware	
Drop Seals	Surface, semi-mortised or mortised	
Special Details	Machining for hardware; installation of lites; sketch faces (same both faces); solid wood grillwork and divided lites, shallow (3/64") reveals	
Finish	UV-cured, primed, sealer, full sealer, catalyzed polyurethane and opaque varnish	
Warranty	One year from date of original installation - not suitable for exterior installations	
LEED Contributions	MR 4: Recycled Content; EQ 4.4: Composite Wood, Agrifiber, and Adhesives Contain No Added Urea-Formaldehyde	

¹Other sizes and thicknesses may be available with additional engineering and lead time



Stile and Rail Doors, Door Frames
Veneered Components, Plywood

Two Rivers Division
One Eggers Drive
Two Rivers, WI 54241
Phone: 920.793.1351
Fax: 920.793.2958

Flush Doors

Neenah Division
164 North Lake Street
Neenah, WI 54956
Phone: 920.722.6444
Fax: 920.722.0357

Architectural Veneer Faces,
Custom Wood Products, Plywood

Kentucky Division
2125 Lake Jericho Road
Smithfield, KY 40068
Phone: 502.845.0154
Fax: 502.849.0444