



Eggers Industries

Introducing **FLUSH DOORS** for Behavioral Healthcare Facilities

Doors in all healthcare environments are put to the test on a daily basis and behavioral healthcare facilities are no different. These doors must be designed with security, dependability and safety in mind.

Eggers' eiDoor® provides a beautiful, yet functional impact-resistant answer for these facilities. The addition of a wicket or *“Door within a Door”*, can provide healthcare professionals access to the patient's room in case of an emergency.

With patient safety being a primary benefit to this new offering, this door is an excellent choice for:

- Behavioral Healthcare Units
- Hospitals & Surgery Centers
- Rehabilitation Centers
- Senior Living Residences
- Correctional Institutions

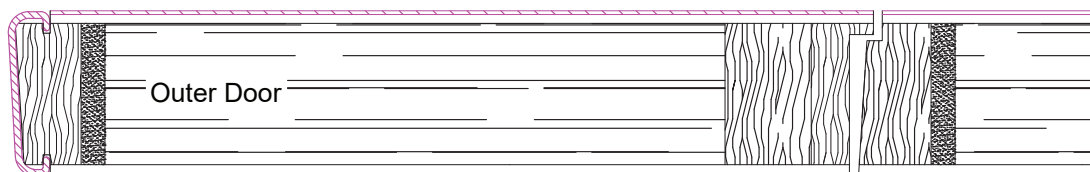
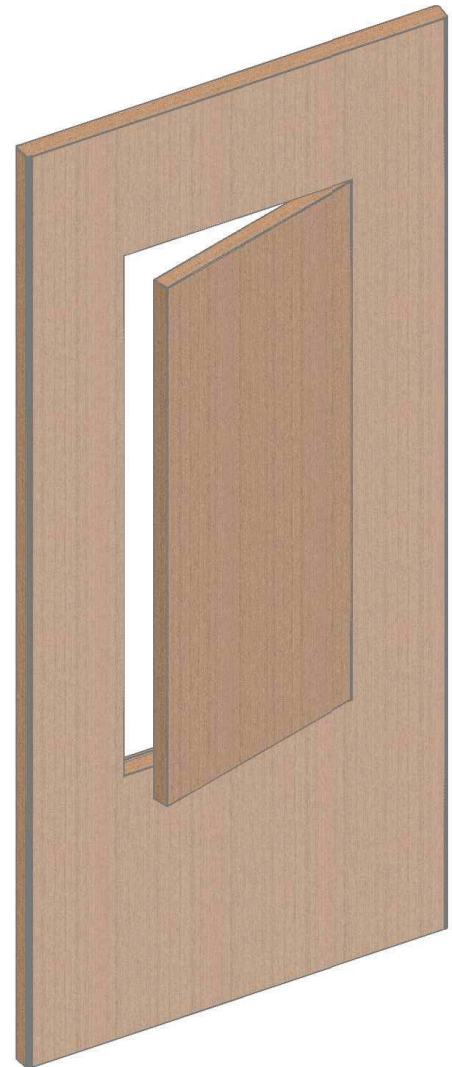

ENGINEERING SPECIFICATIONS

FLUSH DOORS with a Wicket for Behavioral Healthcare Facilities

	Non-Rated	20-Minute
Max. Size	4' x 8'	
Thickness	1-3/4"	
Core	Structural composite lumber (SCL), FSC® certified structural composite lumber	
Transoms	N/A	
Stiles	Solid lumber edges for removable edge construction; veneered structural composite lumber for fixed vinyl or veneer-banded edges	
Rails	No-rail construction is standard for SCL	
Faces	Inpro IPC® Rigid Sheet (PVC) and G2 BioBlend® (non-PVC) - 0.40" (1mm) standard thickness All domestic and foreign veneers, medium density overlay (MDO), and high pressure laminates are also available.	
Crossbands	1/11" high density fiberboard	
Wicket Specifications	<ul style="list-style-type: none"> • Wicket size determined by hardware, lites and edge margins • Location will be centered in the door • 10" minimum bottom rail required • 1/4" by 1/4" rabbet • Inside edges of cutouts will be painted/stained to match 	
Lites	<ul style="list-style-type: none"> • Lites allowed based on minimum cutout dimensions between lite and wicket • 6" required between lite and wicket • 6" minimum stiles - 1-1/2" required between lock and lite cutout • 10" bottom rail required • Inside edges of cutouts will be painted/stained to match 	
Louvers	N/A	
Latching Hardware	Cylinders, mortised, unit or card	
Hinges	Per NFPA 80 - butts, continuous hinges, pivots (electrical options available)	
Flushbolts	N/A	
Fire Exit Hardware	N/A	
Closers, Stops, Holders	Listed surface hardware or concealed hardware having mortise up to 23-3/4" x 1-1/2" x 1-3/8"	
Drop Seals	Listed and approved surface, semi-mortised or mortised	
Finish	Veneered and Paint Grade Doors: UV-cured, primed, painted (MDO only), sealer, full sealer, catalyzed polyurethane and opaque varnish	
Warranty	Life of installation (interior)	
Standards	WDMA I.S. 1A, AWS Section 9 Edition 2, NFPA 252, UL 10B, UL 10C, NFPA 80	



Stile & Rail Doors, Door Frames, Plywood Veneered Components

Two Rivers Division
One Eggers Drive
Two Rivers, WI 54241
Phone: 920.793.1351
Fax: 920.793.2958

Flush Doors, eiDoor®

Neenah Division
164 North Lake Street
Neenah, WI. 54956
Phone: 920.722.6444
Fax: 920.722.0357

Architectural Veneer Faces, Custom Wood Products, Plywood

Kentucky Division
2125 Lake Jericho Road
Smithfield, KY 40068
Phone: 502.845.0154
Fax: 502.845.0615