

Architectural Wood Door Schedule

Customer P.O. Number Job Name & Address
 Owner Name Quote Number Contractor Name, Address, and Phone

SPECIFICATIONS

DOOR GRADE WDMA AWS AWI/QCP
 Custom Grade Premium Grade

FACES

Cut and Species-
 Veneer Grade - Paint Grade A Grade AA Grade
 Veneer Match - Book Slip Swing Random Sketch
 Face Assembly - Run Balance Center Balance Random

PREFINISHING

Per Eggers Approved Sample #

EDGES

Veneered (Std. on Flush Doors)
 Solid Lumber (Std. on Specialty Flush and All Stile and Rail Doors)

ENVIRONMENTAL REQUIREMENTS

LEED® FSC® CERTIFIED NO ADDED UF CARB

STILES & RAILS - Eggers standard construction unless otherwise specified

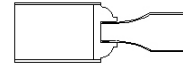

S/R STICKING

Ovolo
 Quarter Round
 Ogee
 Square
 Other

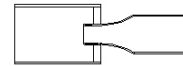
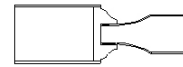
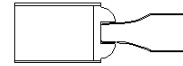

Additional to Previous Order

Previous Order #

OR

Previous PO #

Notes:

ONLY FOR USE ON ORDERS COORDINATED BY EGGERS

PREFITTING CLEARANCES

Top Hinge Stile Lock Stile
 Between Pair Leaves
 Double Egress Hinge Stile Lock Stile
 Undercut
 Other

GLAZING

By Eggers By Others
 Bead # MVP #
 Patterned/Textured Glass to Face:
 Inside Outside

EDGE MACHINING

STANDARD RULE: Bevel both edges 1/8" in 2"
 OTHER STANDARD: Hinge: Bevel Square
 Lock: Bevel Square
 RADIUS: 1-1/4" 1-3/4" 2-5/8"

FRAME INFORMATION

Frame Manufacturer
 Frame Type: Steel Wood Aluminum
 Frame Application: Interior Exterior

Flush Doors

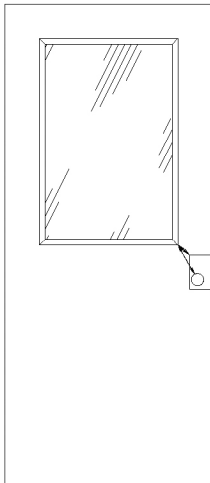

To Avoid Conflicts between Lite and Lock

For Non-Rated and 20-Minute Particlecore Doors
 Allow a minimum of 3-5/16" of core between lite and lock cutouts, and 5" from edge of door to lite cutout to maintain warranty.

For All Rated Doors (45, 60 & 90 Minute)
 Allow a minimum of 3-1/2" of core between lite and lock cutouts, and 5-1/2" of core from edge of door to lite cutout to maintain label and warranty.

Our Full Lite Door Construction for Non-Rated and 20-Minute
 Can maintain a warranty with only 1-1/2" of core between lite and lock cutouts.

Our Full Lite Door Construction for 45-Minute
 Can maintain a warranty with only 3" of core between lite and lock cutouts and 7-1/8" stiles for doors with concealed vertical rod hardware utilizing SCL core.

Note: When using a metal vision frame, allow for oversized frame cutout.



Stile and Rail Doors, Door Frames
 Veneered Components, Plywood

Two Rivers Division
 One Eggers Drive
 Two Rivers, WI 54241
 Phone: 920.793.1351
 Fax: 920.793.2958

Flush Doors

Neenah Division
 164 North Lake Street
 Neenah, WI 54956
 Phone: 920.722.6444
 Fax: 920.722.0357

Architectural Veneer Faces,
 Custom Wood Products, Plywood

Kentucky Division
 2125 Lake Jericho Road
 Smithfield, KY 40068
 Phone: 502.845.0154
 Fax: 502.849.0444